

## CARTRIDGE USE

The Optimum 4000 is designed for use with Vaportek approved replacement cartridges only. Use of non-approved replacement cartridges will void warranty coverage. For best results, store cartridges in a cool, dry location and keep away from extreme heat. Replace cartridges after 3-4 months of use. The membrane inside the cartridge is sealed. Do not puncture or open the internal membrane. We recommend Neutral/3X Industrial and/or Smoke Odor Solution (S.O.S.) replacement cartridges for odor elimination.

### Reorder Information:

**Optimum 4000 (#90-4000)**  
**High Output cartridge (#90-4120 Series)**  
**Standard cartridge (#90-4090)**  
**3X Industrial cartridge (#90-5150)**  
**S.O.S. cartridge (#90-5150-85)**  
**Wall-mount Bracket (#90-0924)**

### Five Year Limited Warranty

Vaportek warrants this unit to be free from defects in workmanship and materials, under normal use and service, for five years from date of purchase by the original purchaser. If, at any time during the warranty period, the product is found to be defective or malfunctions, Vaportek will either repair or replace the defective part(s) at its discretion. Warranty does not apply if it is shown by Vaportek that the defect or malfunction was caused by unauthorized modifications, neglect, or abuse by the consumer. Further, any costs incurred by consumer due to unauthorized changes made to the product will not be covered by Vaportek. This warranty does not cover any other charges incurred by the consumer. Vaportek's sole responsibility is to repair or replace product within the terms stated above.

Vaportek shall not be liable for any consequential damages resulting from any breach of warranty, expressed or implied, applicable to this product. Some states do not allow the exclusion or limitation of consequential damages, so this limitation may not apply to you.

This warranty is in lieu of all other warranties, expressed or implied. The warranties of merchant ability and fitness for a particular purpose are hereby excluded beyond the five year duration of this warranty. Some states do not allow limitation on how long an implied warranty lasts, so the above limitation may not apply to you. This warranty gives you specific legal rights, and you may also have other rights which can vary from state to state. This warranty applies only to products sold and used in the United States and Canada. Goods submitted for repair under this warranty must be sent, freight prepaid, to Vaportek, Inc. Call first for a return authorization number.

For service advice, contact your dealer or

**VAPORTEK** 

P: 800.237.6367 | F: 262.246.5065  
www.vaportek.com | info@vaportek.com  
W226 N6339 Village Drive, Sussex, WI 53089 USA

# USE AND OPERATING INSTRUCTIONS FOR THE OPTIMUM 4000™

## 110 / 120V



### Optimum 4000™ An Odor-Neutralizing System

The Optimum 4000 is an easy-to-use, virtually silent, stationary system. Primarily intended for constant deodorization. This unit is safe to use in occupied spaces.

#### Easy-to-Use

Just uncap the cartridge, insert into machine, and turn on.

#### Works 24/7

Treat areas where continual deodorization is needed because the source of the malodor remains.

#### Economical

Lasts 3-4 months.

Proudly made in the USA



## THANK YOU

Thank you for purchasing the Optimum 4000 by Vaportek. The unit is an easy-to-use, virtually silent, stationary system. It treats areas up to 20,000 ft<sup>3</sup> to effectively eliminate odor contamination steadily and safely. The unit is primarily intended for delivering a long-lasting treatment solution. A characteristic neutralizer fragrance will be noticeable during operation as the essential oil dry vapor circulates throughout the treatment area. Residual fragrance will dissipate in a matter of hours after treatment ends. With proper care, your Optimum 4000 will provide you years of trouble-free service. Please read these use and operating instructions carefully before operating your new machine and keep it for future reference.

## SUGGESTED USES

### ODOR ELIMINATION

Unit can be used to eliminate odors using our Neutral/3X Industrial and/or Smoke Odor Solution (S.O.S.) formulas. For areas with any ongoing, organic odors, run the unit continuously to eliminate odors.

### AROMA DIFFUSERS

For aromatherapy/hospice uses, choose from an array of fragrances, including our odor eliminating formulas. Vaportek's aromatherapy line was introduced in 1993 to help provide customers, who had discovered the therapeutic benefits and unique aesthetic enjoyment of using essential oils, with the ability to enhance and improve their indoor environments. By combining our extensive worldwide experience in air cleaning and odor control with experts in the field of aromatics, we developed our own innovative technology to safely deliver a variety of pleasing aromas throughout large open spaces or selected interior areas.

### IDEAL FOR:

- ◆ Real Estate/Foreclosures
- ◆ Homeless Shelters
- ◆ Office Spaces
- ◆ Long-term Patient Facilities
- ◆ Athletic Facilities/Locker Rooms
- ◆ Vehicle/Boat/RV
- ◆ Medical Facilities
- ◆ Smoking Areas
- ◆ Musty Basement
- ◆ Daycare Centers
- ◆ Spas

Ratings:  
13W  
110/120V



## INSTRUCTIONS

Ensure unit is plugged into the correct outlet. Situate unit so air flow at both ends is unobstructed, preferably in a relatively high location. Place on a firm, stable surface. Ensure cartridge is properly installed with the plastic cap removed from the cartridge prior to installation. To preserve cartridge life, always store with the cap on when not in use. Deodorization will occur continuously. Rotate the dial face to control dry vapor output and intensity using 1 for the lightest output and 10 for the strongest. For applications where security is a concern, an optional wall-mounting bracket with padlock allows for permanent installation and prevents unauthorized access to the output control dial.

## IMPORTANT

As with any powered tool, certain precautions for safe and efficient use apply. Please follow these rules and recommendations when using the Optimum 4000:

1. Use Vaportek approved accessories only.
2. If the supply cord is damaged, it must be replaced by the manufacturer, its service agent, or a similarly qualified person in order to avoid a hazard.
3. The membrane inside the cartridge is sealed. Do not puncture or open the internal membrane.
4. Do not allow membrane oils to come in contact with finished surfaces. Finished surfaces may be damaged by direct contact with oils. If oils should leak, wash affected skin, clothes, and/or surfaces with soapy water.
5. For best results, store cartridges in a cool, dry location and keep away from extreme heat.
6. Replace cartridges after 3-4 months of use depending on your output settings.
7. Dry vapor output will be affected by humidity, airflow, and temperature. Ideal dry vapor release occurs at 50-80°F. Vapor release significantly increases in excess of 90°F.
8. To extend cartridge life, re-cap it when not in use.
9. Do not immerse or use where contact with water may occur.
10. Do not alter the plug or change the electrical wiring.
11. If unit appears to malfunction, unplug or turn it off immediately. Contact your dealer or Vaportek for service advice.
12. Vaportek products use natural essential oils. If an allergic reaction occurs, please discontinue use immediately.
13. To accelerate the dissipation period of the characteristic Vaportek fragrance, open windows and turn on floor fans.
14. This system provides a safe, effective *alternative* to ozone. It is *not* recommended for use with ozone generating equipment.
15. Designed for continuous, long-term operation.
16. Use standard disinfectant wipes to clean water safe surfaces.

## Optimum 4000™

Fig. 1



Turn off machine. Lift off cartridge lid & discard clear film liner. Cartridge life is rated at 3-4 months.

Fig. 2

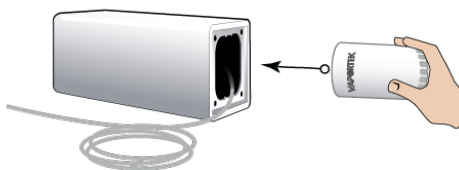

Insert open end of cartridge into back of machine, seating firmly against internal gasket.

Fig. 3



Replace spring-loaded rear cover plate by pressing it against the cartridge while turning until it locks into place.

Fig. 4

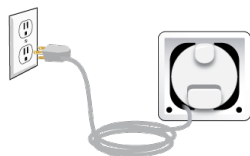

To operate, plug cord into power outlet. Always unplug Optimum before removing cartridge. The cord can be coiled for storage in the back of the rear cover plate.

Fig. 5



Rotate the dial face to control dry vapor output and intensity using 1 for the lightest output & 10 for the strongest.